



STANDARD®

CMB8

MOBILE BRACKET

INSTRUCTIONS MANUAL

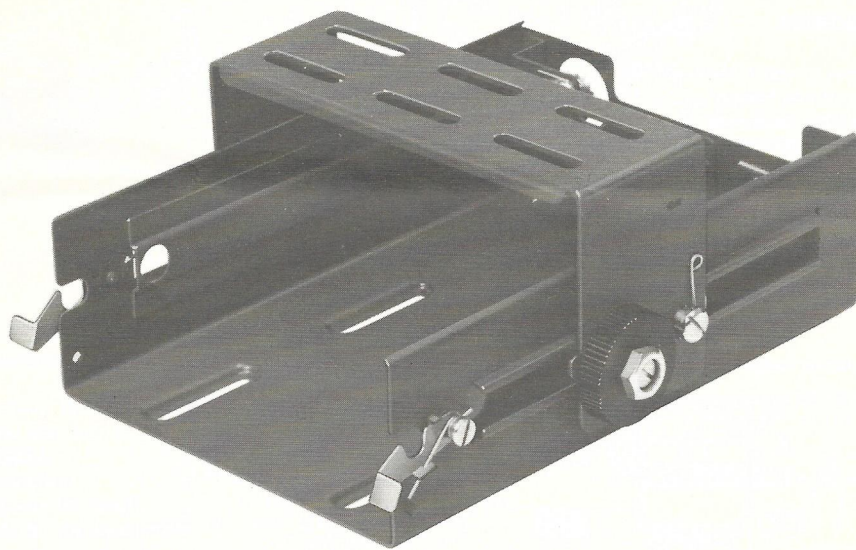

STANDARD COMMUNICATIONS CORP.

**Downloaded by
RadioManual.EU**

Please inspect your Bracket carefully for any signs of shipping damage. Our very strict quality control and professional pride ensure that each Bracket left the factory in perfect condition. Should your Bracket malfunction, immediately contact the dealer from which you purchased it or the nearest authorized service station.

FEATURES

- * Your transceiver unit can be pushed into and popped out of the bracket without requiring antenna or power connection.
- * The bracket position is longitudinally adjustable. Its vertical angle is also adjustable in three steps.
- * Attachment of the optional power booster to the bracket turns your 1-watt transceiver into a 10-watt rig.
- * A single push of a lever snaps the transceiver set out of the bracket.

ACCESSORIES

DC power cable (with 4A fuse)	1
Microphone hanger	1
Retention hardware	
For bracket: Bolts (M3 x 20)	4
Nuts	4
Washers	4
Spring washers	4
For microphone hanger:	
self-tapping screws	
(3 x 12)	4
self-tapping screws	
(3 x 30)	4
Antenna holder	1

Downloaded by
RadioManual.EU

INSTALLATION

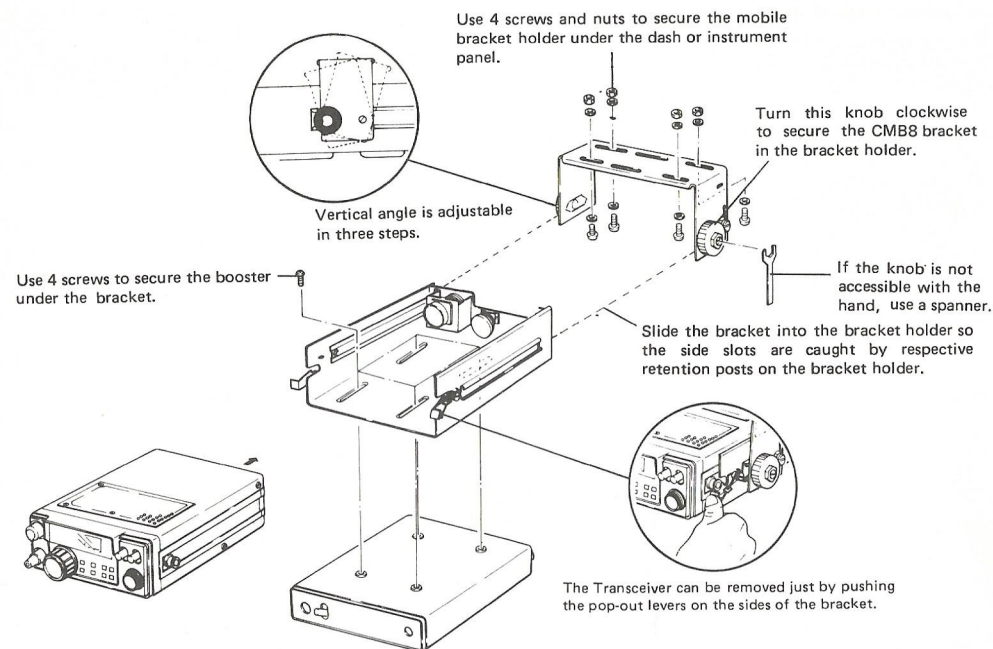

NOTE:
Insert the unit until both levers lock the unit.

Mobile Installation

Installing the Power Booster in your car requires the use of an optional Mobile Bracket (CMB8)1

- * Location
- 1. Under the dash
- 2. Under the instrument

- * Decide the unit's position by taking into account the following points:
- 1. It is easily accessible.
- 2. The display on the unit is easy to read.
- 3. It is not too close to heating or cooling systems.
- 4. It is protected from rain or water splashes.

NOTE:
Fit the supplied microphone hanger at a convenient point.

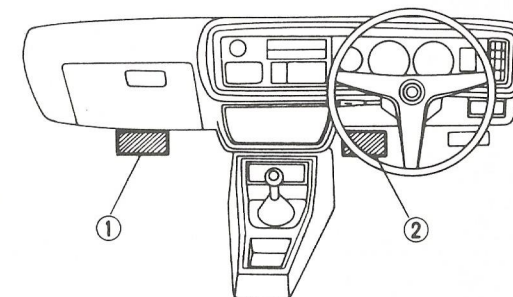

Antenna Cable Connection

- * Lead the cable in through the bonnet of a car.

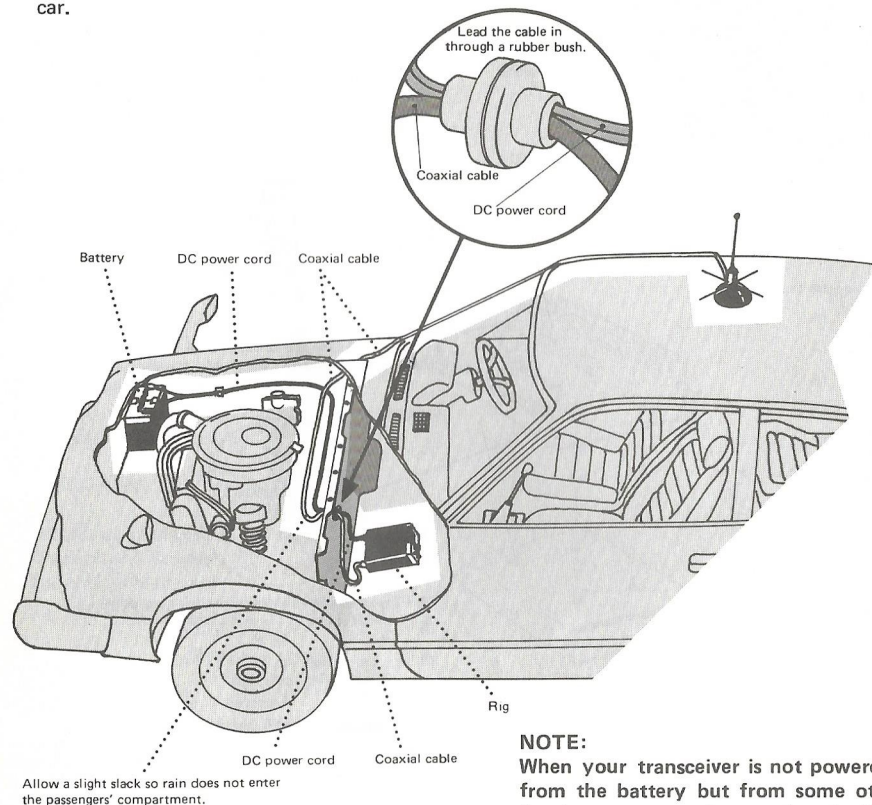

NOTE:

When your transceiver is not powered directly from the battery but from some other power line in your car, make sure that the line remains alive even when the starter is turned on.

CONNECTION

- * DC Power Source and antenna connections to the bracket (CMB8):

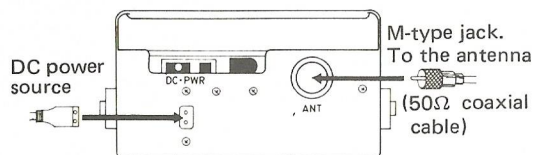

- * When using an external power source, connect up with the supplied power cable.

- * When using an external antenna, remove the helical antenna and store it in the supplied antenna holder.
- * The antenna holder can be fixed as desired, such as on the CMB8 side plate or the booster bottom cover.

Remove the cover from the adhesive tape and fix the antenna holder in the desired position. Applying excessive force to the antenna holder just after installation will peel it off. Leave the holder for 24 hours after installation.

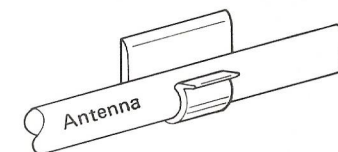
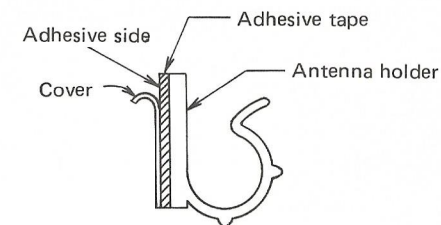

- * Power and antenna connection to the power booster:

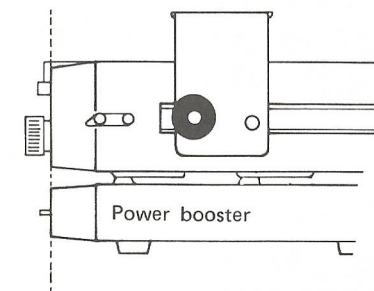
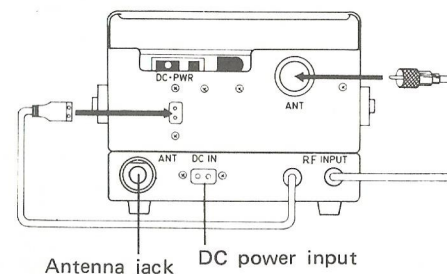

For normal use, align the front faces of the transceiver unit and the power booster as shown below. If this is inconvenient, the power booster may be recessed slightly.

When using your transceiver as a base station, use an optional power supply (STANDARD Model: CPS02).

- * When your transceiver is used in a mobile bracket which has an external antenna, ensure that the transceiver's built-in antenna is fully retracted, or that the antenna supplied with the transceiver unit is disconnected from its jack.

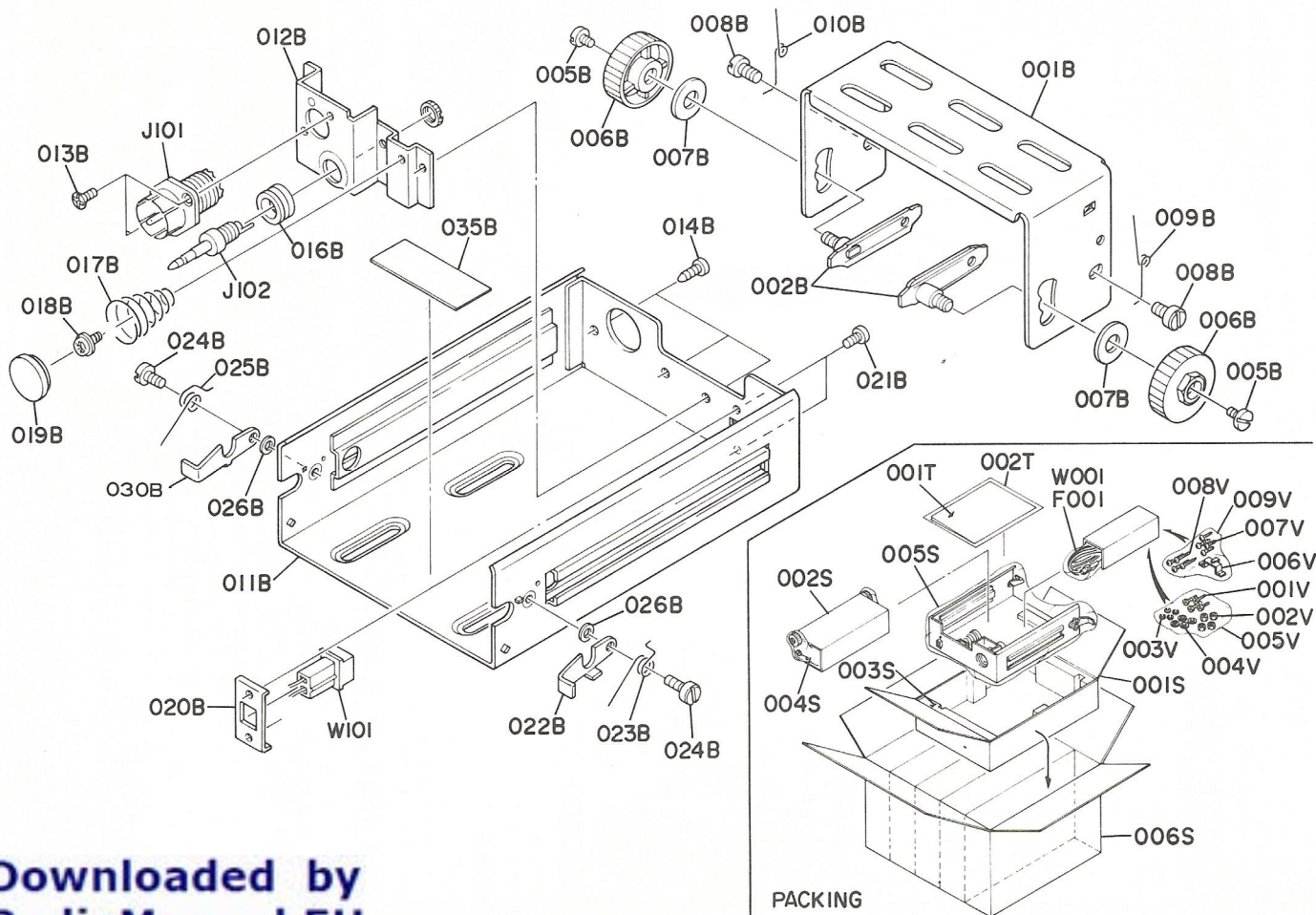

Downloaded by
RadioManual.EU

REF. DESIG.	Q'TY	PART NO.	DESCRIPTION
001B	1	202C160010	Bracket, Slide
002B	2	4723051510	Guide, Assembly
005B	2	4723114010	Stopper
006B	2	4723154100	Knob, Bracket
007B	2	4723118050	Spacer
008B	2	4723271010	Holder
009B	1	4723115010	Spring, Right
010B	1	4723115020	Spring, Left
011B	1	202C064010	Case
012B	1	202C160020	Bracket, ANT
013B	2	51040306B9	F.H.M. Screw F3 x 6
014B	3	51280306U0	B.H. Tapped Screw B3 x 6
016B	1	202C259020	Bushing
017B	1	202C115040	Spring
018B	1	51100305S9	B.H.M. Screw B3 x 5
019B	1	202C259010	Bushing
020B	1	3667005010	Clamper
021B	2	51102604S0	B.H.M. Screw B2.6 x 4
022B	1	202C354010	Lever
023B	1	202C115020	Spring
024B	2	202C112010	Shaft
025B	1	202C115030	Spring
026B	2	54022601E0	Washer
035B	1	202C056010	Buffer
030B	1	202C354020	Lever

REF. DESIG.	Q'TY	PART NO.	DESCRIPTION
J101	1	YJ10001570	Jack, M Type P-J Connector
J102	1	YP01000303	Plug, Non Short
W101	1	YB00120040	Connective Cord
001S	1	202C801020	Packing Case
002S	1	202C803010	Partitioner
003S	1	202C809010	Cushion
004S	1	9011530010	Polyethylene Bag
005S	1	9013035010	Polyethylene Bag
006S	1	202C805020	Master Carton
001T	1	202C851110	Instructions, Owners manual
002T	1	9012025010	Polyethylene Bag
001V	4	52030520B9	H. Head Bolt, P 5 x 30
002V	4	53110503B9	Hexagon Nut
003V	4	54040502B0	Spring Washer
004V	4	54020501B0	Flat Washer, P.
005V	1	9011010010	Polyethylene Bag
006V	1	4723155010	Hanger
007V	4	51280312B0	B.H. Tapped Screw B3 x 12
008V	4	51380330A0	P.H. Tapped Screw P3 x 30
009V	1	9011010010	Polyethylene Bag
F001	1	FS10400600	Fuse 4A
W001	1	YC02500090	A.C. Power Cord
007S	1	202C803020	Partitioner